



COOPERATIVE STRATEGIES

COMPLETE FINANCIAL & DEMOGRAPHIC PLANNING FOR EDUCATION

SCHOOL BOARD UPDATE

NORFOLK PUBLIC SCHOOLS

NOVEMBER 28TH, 2018



AGENDA

- 1. Lake Taylor MS K8 Meeting - Recap**
- 2. Current & Future Educational Planning Initiatives**
 - School Start Times
 - Pre-Kindergarten Facility Planning
 - Feeder Pattern Analysis



3 Discussion Points

- Curriculum/Program Delivery
- Facilities
 - Facility Condition
 - Enrollment/Utilization
 - Current Configuration – LTMS
 - Draft Renovations – LTMS
 - Draft Configuration - LTMS
- Transportation

FEEDER PATTERN

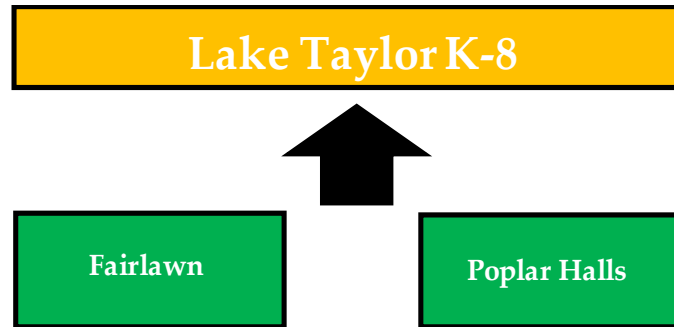

SY2017-18

- Campostella, St. Helena, Poplar Halls, Fairlawn and Ingleside previously had students attend Lake Taylor MS

SY2018-19

- Southside Stem Academy @ Campostella now has grades K thru 8
- St. Helena students now attend Blair MS

Propose

- Students from other elementary schools currently feeding Lake Taylor MS, will be reassigned according to proposed feeder pattern realignment in Long Range Facilities Master Plan
- The Poplar Halls/Fairlawn K-5 attendance zone would make up the boundary for the proposed Lake Taylor K-8

K-8 Schools

- Subject curricula traditionally build each year and a K-8 school builds a bridge between elementary and middle school.
- The K-8 school allows for the possibility of better collaboration on the vertical implementation of all subjects related to the essential skills found in the state curricula.

K-8 Schools

- A huge benefit in the K-8 schools occurs when transition can be seamless as students move from elementary to middle school.
- You can begin to create the mindset of the demands of middle school in 4th and 5th grade. This benefits the accelerated students by providing them with advanced opportunities.
- Teachers of struggling 6th graders can benefit from having the 5th grade teachers and curriculum within the same building...allowing scaffolding to occur between elementary and middle school.

FACILITY CONDITION



School	Facility Condition Index	Capital Renewal Costs	Capital Renewal + Educational Renovations
Fairlawn ES	65%	\$7,250,000	\$9,060,000
Poplar Halls ES	73%	\$6,540,000	\$8,175,000
Lake Taylor MS	68%	\$18,500,000	\$23,100,000

ENROLLMENT/UTILIZATION



	Building Capacity	Portable Capacity	Total
Elementary	529		529
Middle	368	92	460
Total	897	92	989

- Estimate under 900 K-8 students (Fall 2019)
- All current 6th and 7th grade Lake Taylor MS students can continue attending Lake Taylor MS
- Estimated 2021-22 enrollment is approximately 750 students

LAKE TAYLOR-CURRENT CONFIGURATION

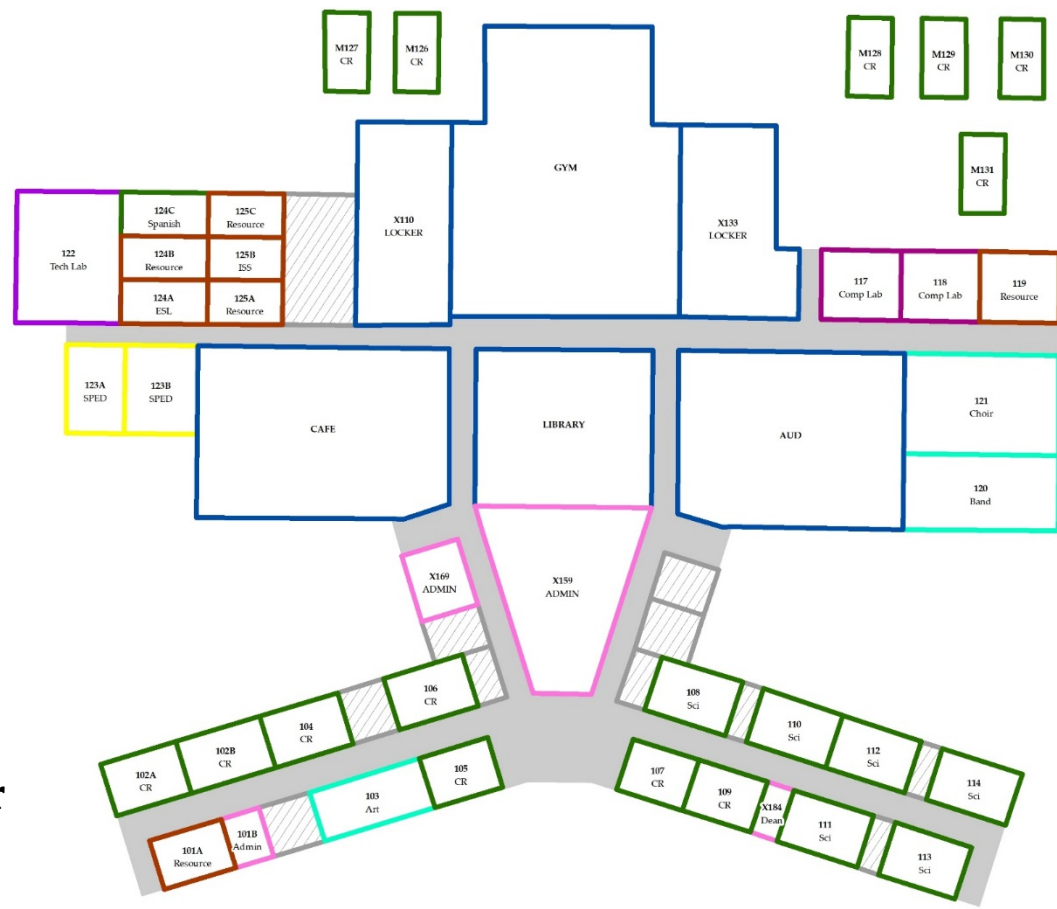
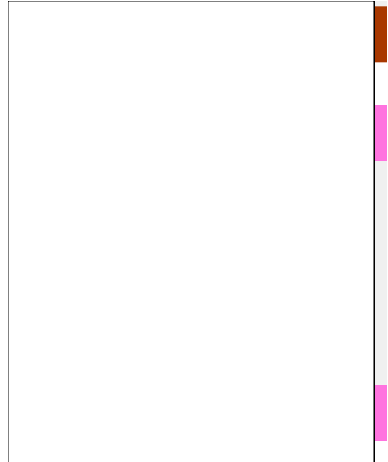

1st Floor

LAKE TAYLOR-CURRENT CONFIGURATION

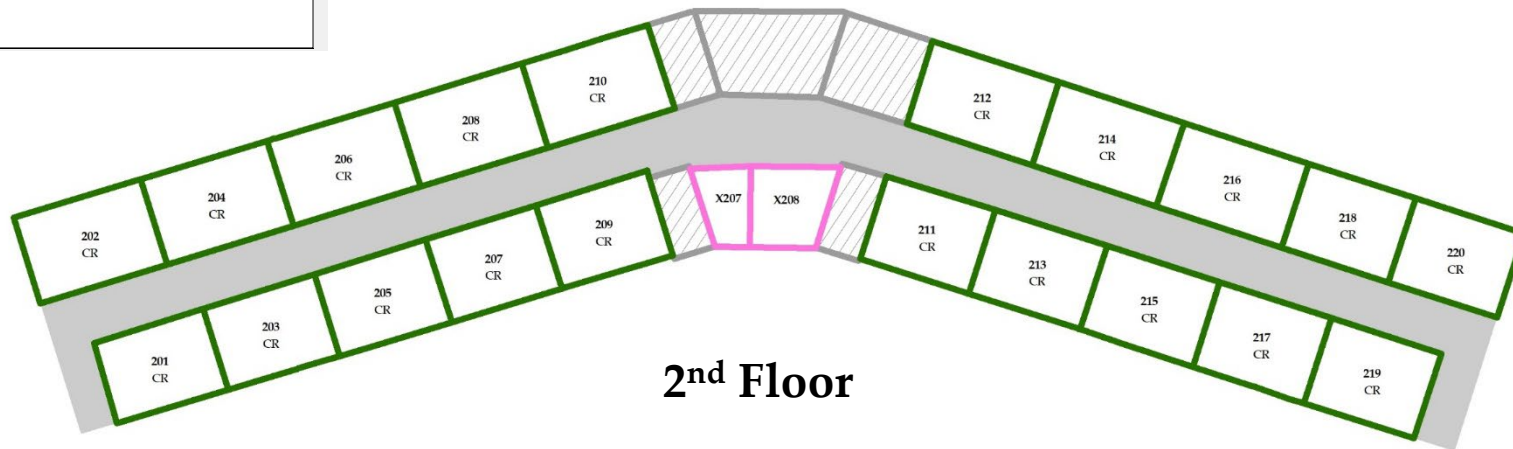
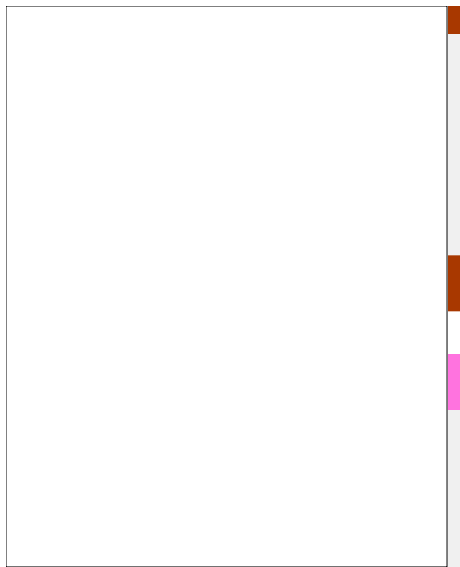

LAKE TAYLOR – DRAFT RENOVATIONS



LAKE TAYLOR – DRAFT RENOVATIONS



- Convert 101A from Resource to Classroom
- Convert 103 from Art room to Sci Lab
- Convert 103A from storage to Sci Prep
- Convert 104 (classroom) and X171 (Storage, Old Home Ec.) to Sci Lab
- Convert 115 from storage to Resource
- Convert 117 & 118 (Comp Labs) to Low Incident SPED rooms (Major Reno needed)
- Convert 119 (Resource) to OT/PT
- Convert 123A & 123B from Low Incident SPED to Comp Lab
- Convert 124A, 124B, and 124C to Art
- Convert 125A, 125B, and 125C to Art



LAKE TAYLOR – DRAFT K-8 CONFIGURATION



1st Floor

LAKE TAYLOR - DRAFT K-8 CONFIGURATION

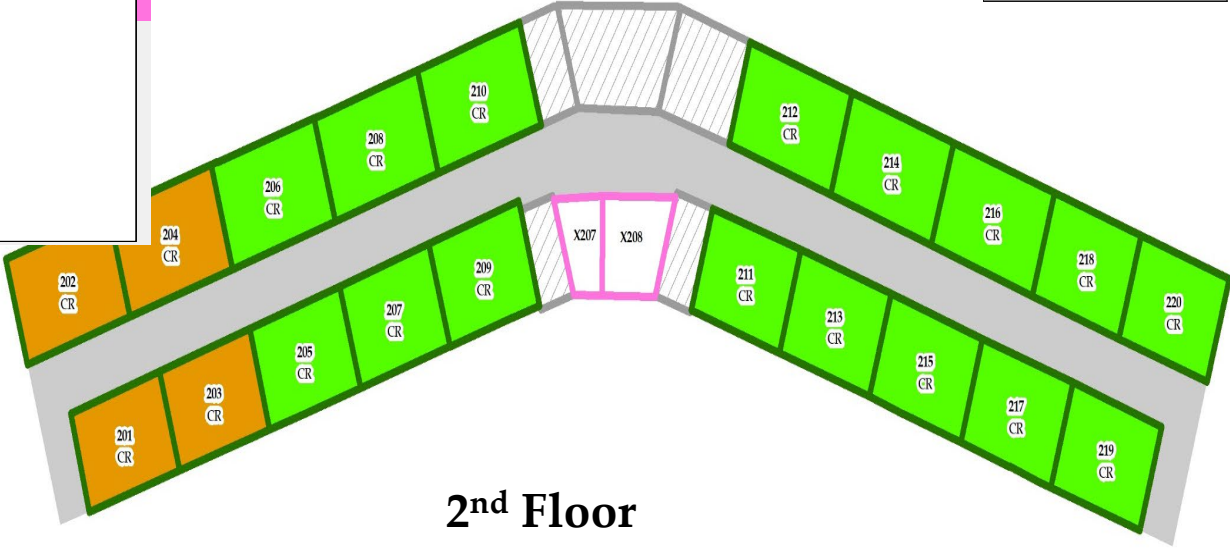
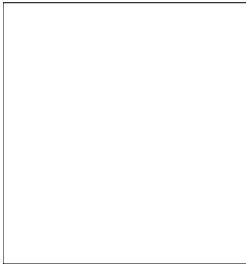
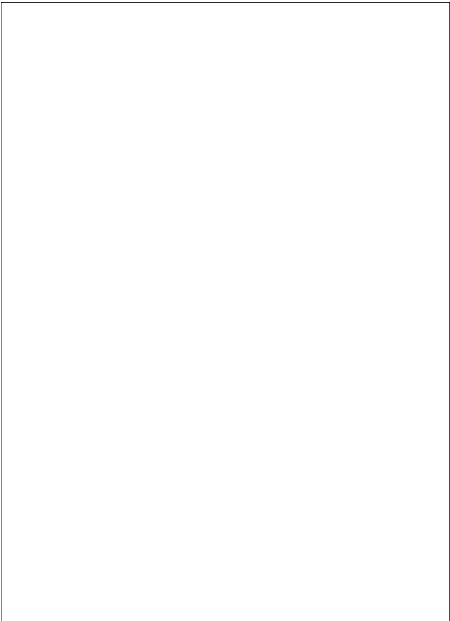

2nd Floor

TRANSPORTATION



- Currently most students receive bus transportation to Lake Taylor MS
- As a K-8, majority of students would be transported to Lake Taylor facility

	1 Mile	2 Mile	3 Mile	4 Mile
K-5	89	311	204	14
6-8	35	119	85	7

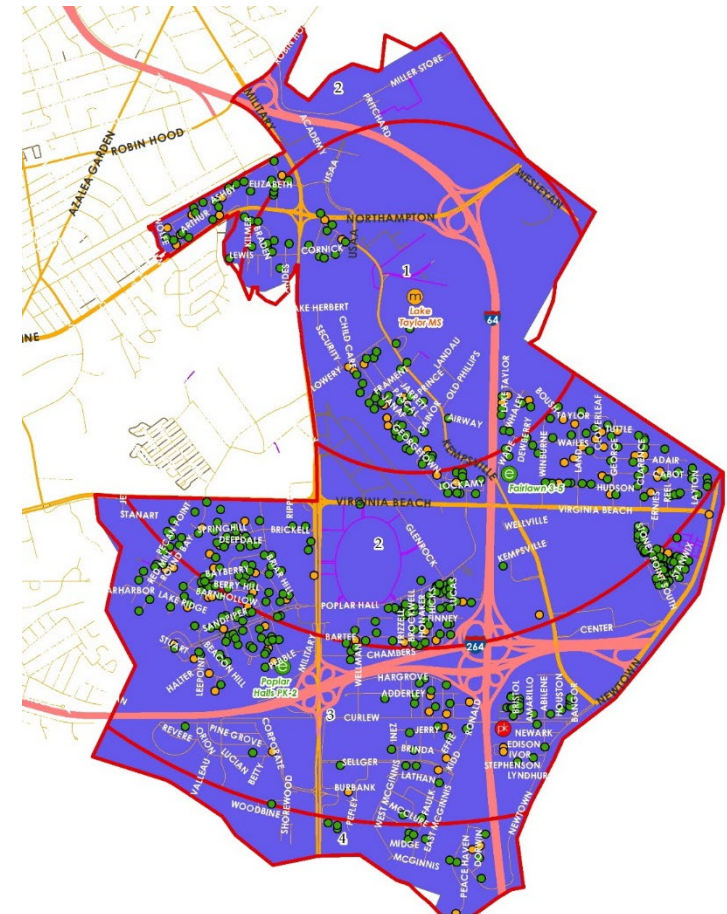

SURVEY RESPONSES

LAKE TAYLOR MS MEETING



- This is good. A start. Keep consolidating. I pay taxes and we pay too much for old building maintenance. Close and consolidate more schools.
- Will the school be only for the Poplar Halls and Fairlawn Elementary school zoning districts? What is going to happen to Fairlawn Recreation Center? Why are they closing two school in the same zoning District? Why not make Fairlawn K through 5 school as it was in the past.
- Not happy with age gap of students. I think elementary age kids do not belong with 8th grade kids.
- Not enough sidewalks for pedestrians on Kempsville. No crossing guards (maybe I haven't seen them) on Kempsville. Traffic in Kempsville is terrible, consider police to ease traffic during rush or light adjustments.



SURVEY RESPONSES

LAKE TAYLOR MS MEETING

- What will be the school hours for the K-8 Lake Taylor school? When will this transition happen?
 - As a single working mom, I'm very concerned with before school and after school childcare or programs. Will there be such a program established? Also very concerned with the lack of advance notice to the public regarding the last meeting regarding this topic.
- K-8 is a good idea however consider that past K-8 have grown from new construction from an existing ES school / adding a MS, not a reno and not in reverse. Elementary needs a dedicated classroom for K-5 music. MS has band, chorus and orchestra. Suggest housing orchestra in auditorium. No restrooms for K classes. One gym not enough for ES and MS.



SURVEY RESPONSES

LAKE TAYLOR MS MEETING

- Why not just close Poplar Hall and convert Fairlawn to K-5? How will before and after care be handled? Concerns of security regarding having young kids to teenagers in the same building. Projected classroom size for each grade; is it conducive for learning? What will happen to the school buildings no longer in use?
- NPS Needs to offer 3 options for elementary/middle school facilities instead of K-8 model.
- NPS current staffing shifts/future staffing needs to be addressed for all schools affected.
- More public meetings should be scheduled for every area of the city for the communities and the school staff before any recommendations are given to the School Board for final consideration/approval.
- NPS is not doing a good job with marketing and advertising information via website/city media/civic league/church/stakeholder engagement. The Educational Planning Task Force is not receiving enough support and communication from NPS.



ADDITIONAL OPTIONS

- Close Lake Taylor MS facility
 - Move 6-8 students to Ruffner
 - Leave Poplar Halls and Fairlawn open
- Repurpose Lake Taylor as an elementary school with students from Ingleside, Poplar Halls, and Fairlawn.
 - 6-8 students would attend Ruffner.
 - Would require some elementary rezoning for all students to fit in Lake Taylor

CURRENT/FUTURE PLANNING INITIATIVES



School Start Times

- Continued Research and Community Input
- Yellow-Bus Transportation Improvements

Pre-Kindergarten Planning

- 2019/20 Program Placement
- Standards Development for Elementary School Spaces

Feeder Pattern Analysis

- Opportunities for Improved Feeder Patterns: Short and Long-Term



NEXT STEPS

Community Task Force

- Monday December 10th

Community Meeting

- December 17th



QUESTIONS